

CS21 Series 1.27mm(.050") DIP PLCC Chip Carrier Socket

- With standoff prevent flux wicking
- Low cost and reliable
- Insulation: Glass filled polyester or PPS UL 94V-0
- Contact: Tin plated Phosphor Bronze

RoHS Compliant

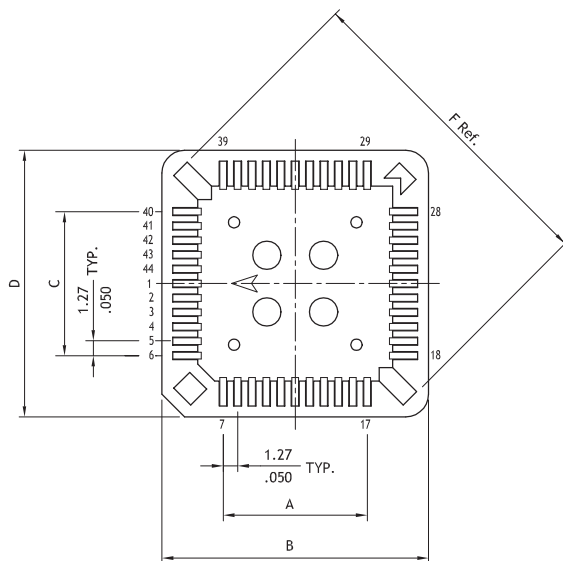
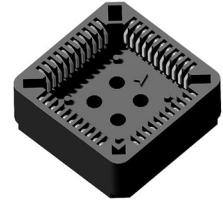

Available for 20,28,32,44,52,68,84 Circuits

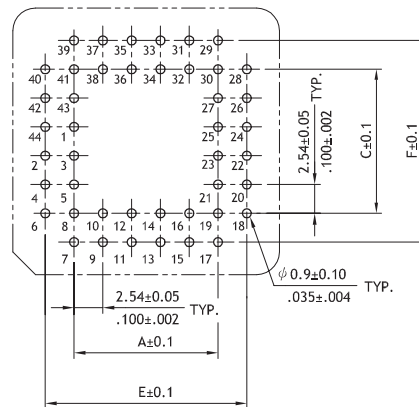

Recommended P.C. Board Layout

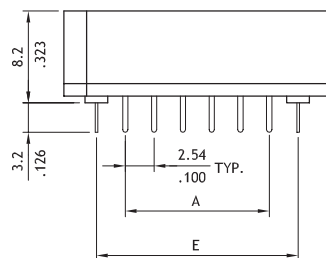

Circuits	Dimension					
	A	B	C	D	E	F
20	5.08(.200)	15.5(.610)	5.08(.200)	15.5(.610)	10.16(.400)	16.8(.661)
28	7.62(.300)	18.0(.709)	7.62(.300)	18.0(.709)	12.70(.500)	20.7(.815)
32	10.16(.400)	20.6(.811)	10.16(.400)	20.6(.811)	15.24(.600)	22.6(.890)
44	12.70(.500)	23.5(.926)	12.70(.500)	23.5(.926)	17.78(.700)	28.4(1.118)
52	15.24(.600)	25.9(1.020)	15.24(.600)	25.9(1.020)	20.32(.800)	31.7(1.248)
68	20.32(.800)	31.66(1.246)	20.32(.800)	31.66(1.246)	25.40(1.000)	39.2(1.543)
84	25.40(1.000)	36.66(1.443)	25.40(1.000)	36.66(1.443)	30.48(1.200)	46.2(1.819)

Ordering Code

①
CS21

②
84

③
1

④
1

⑤
000

- ① Series No.
- ② Circuits :
See above table

- ③ Plating code:
1= Tin over Nickel

- ④ Color: 1= Black(PBT)
0= Nature(PPS)

- ⑤ Other options:
000= PBT (Standard)
A00= PPS
*Special options consult manufacturer